

1. CIF-SS uses the NFHS Rulebook. Umpires working CIF-SS games are specifically prohibited by the NFHS Rulebook from using any other code of rules or interpretations from another code to resolve a game situation arising in a CIF-SS sanctioned game.
 - a. True
 - b. False

Reference: 2020 Rulebook, Announcements, Page 2

2. Jones, who is listed on the lineup as the 2nd baseman, reaches 1B safely. Jones puts on a team jacket because it is cold.
 - a. Legal.
 - b. Legal if authorized by the umpire.
 - c. Illegal. Only the pitcher of record is permitted to wear a jacket while running the bases.

Reference: Casebook 1-4-4 Situation A

3. A player is wearing a knee brace with exposed metal hinges.
 - a. The brace is legal with the exposed metal hinges if it is unaltered from original design.
 - b. The brace is not legal and the player must remove it when playing. Exposed metal on a brace is never acceptable.

Reference: Casebook 1-5-8 Situation C

4. Baseballs must have either the NFHS authentication mark or the NOCSAE authentication mark. It is not required to have both, just one or the other.
 - a. True
 - b. False

Reference: Rule 1-3-1

5. The head coach from Team A presents a lineup at the plate meeting, and it is reviewed, confirmed, and accepted as official by the plate umpire. In the 3rd inning the head coach from Team A tells the plate umpire that a player from his team that was not on the lineup has arrived at the field and he wants to add him to the lineup and insert him into the game.
 - a. Illegal. The late-arriving player cannot be added to the lineup once it has been accepted by the plate umpire.
 - b. Legal. The late arriving is added to the list of available substitutes, and then substituted into the game. The head coach for Team A is issued a written warning.
 - c. Legal. The late arriving is added to the list of available substitutes, and then substituted into the game. The head coach for Team A is ejected.
 - d. Legal. The late arriving is added to the list of available substitutes, and then substituted into the game without penalty to Team A.

Rule reference: 1-1-2

6. R1 at first base. F3 has one foot completely in foul territory and one foot completely in fair territory. F1 delivers a pitch that is called a ball. During the pitch, R1 attempts to steal second base but is out on a tag play.
 - a. Legal. F3 is only required to have one foot in fair territory. The play at second base stands, and the pitch is a ball or strike as judged by the plate umpire.
 - b. Illegal. F3 is required to have both feet in fair territory at the time the pitch starts, or the pitch is illegal. R1 is awarded second base and the pitch is nullified.

- c. Illegal. F3 is required to have both feet in fair territory at the time the pitch starts, or the pitch is illegal. R1 is returned to first base and a ball is awarded to the batter.
- d. Illegal. F3 is required to have both feet in fair territory at the time the pitch starts, or the pitch is illegal. The head coach of the offense can take the result of the play or the penalty for an illegal pitch/balk.

Rule references: 1-1-4 and 2-18

7. Team A is in the third-base dugout and is on offense. B1 is left-handed. For his safety, B1 uses the on-deck circle near the first base.
- a. Legal.
 - b. Legal. NFHS rules allow the plate umpire to allow this.
 - c. Illegal. The offense must use the on-deck circle on their side of the field. The umpires are not empowered to change this.

Rule references: 1-2-3 and 2-23

8. Team A is now on defense in the bottom of the 4th inning. At the conclusion of the top of the 4th inning, Team A left a batting helmet in live-ball territory. B4 hits a pop fly ball that is in foul territory. F3 moves to catch the fly ball and trips over the batting helmet. The umpire judges the ball was catchable, and F3 would have caught the ball had he not tripped over the helmet left on the field. The umpire may declare B4 out.
- a. True. That the equipment that F3 tripped over belongs to his own team is irrelevant.
 - b. False. F3 should not benefit from his team's carelessness.

Rule reference: 1-3-7 and casebook 1-3-7

9. B4 hits an out of the park home run. As B4 approaches the plate he intentionally removes his helmet and tosses it into the air in apparent celebration of the home run. B4 then jumps onto the plate.
- a. Illegal. B4 is returned to third base, which is the last base legally touched before he intentionally removed his helmet.
 - b. Illegal. B4 is declared out and the umpire issues a sportsmanship warning to his team.
 - c. Legal. The ball was dead at the time B4 removed his helmet.
 - d. Illegal. B4 scores, but his team is issued a sportsmanship warning.

References: 1-5-1 and casebook 1-5-1 Situation B-a

10. F2's catcher's mask meets NOCSAE requirements. In the 2nd inning the plate umpire notices a screw that holds the mask to the helmet is missing. Despite the missing screw, the mask appears to be otherwise affixed to the helmet, so the umpire allows the catcher to continue using the mask after the catcher and the head coach agree to repair the mask before the catcher returns defensively for the third inning. Is the acceptable?
- a. No, the missing screw must be replaced immediately.
 - b. Yes, in order to maintain pace of play, repairing the mask can be deferred until the following inning.

Reference: Rule 1-5-6

11. R1 on 1B is stealing on the pitch. B1 hits a fly ball to deep right center field. R1 misses 2B and continues to 3B. The batted ball hits the ground and bounces over the outfield fence, and a ground rule double is declared. B1 is awarded 2B and R1 is awarded 3B. B1 touches 1B and continues to 2B per the award and stops. R1 remains at 3B, and makes no attempt to return to 2B and touch 2B. The defense waits until the ball is made live by the plate umpire and immediately appeals properly that R1 never touched 2B.
- a. The appeal is denied. Although R1 did not touch 2B, he was awarded 3B so he is not subject to appeal for missing 2B.

- b. R1 is declared out on appeal. Even though R1 was awarded 3B, he was still required to touch all bases legally.

Reference: Rulebook 2-2 and 5-2-2c

- 12. B4 hits the ball into fair territory near home plate. B4 drops the bat immediately and without any intent to do anything but run to first base. The dropped bat strikes the ball in fair territory. The ball then rolls completely into foul territory, where F2 picks it up. The umpire judges the ball would have remained fair had it not been struck by B4's dropped bat.
 - a. Fair ball...play on.
 - b. Foul ball...B4 returns to the plate to finish his at bat.
 - c. This is interference, and B4 is declared out.

Reference: Casebook 2-5-1 Situation E

- 13. B1 hits a ground ball to F6. F6 fields the ball and throws to F3, but the ball skips. F3 does not catch the ball in his glove or hand but is able to pin the ball against his chest with his forearm just before B1 touches first base.
 - a. B1 is safe. F1 did not legally catch the ball.
 - b. B1 is out. F1 had secure possession of the ball when he pinned it against his body.

Reference: Casebook 2-9-1 Situation B and 2-16-1 Situation D

- 14. B2 hits a bounding ball down the third base line. About 60 feet down the line the ball touches foul territory and the umpire immediately signals and declares the ball foul. The still bounding ball strikes the third base bag moments later and continues bounding into the outfield.
 - a. Fair ball. The umpire's initial mistake is correctable.
 - b. Foul ball. Because a bounding ball was declared foul, the mistake cannot be corrected.
 - c. The erroneous foul ball call can be corrected if the umpire judges the players did not react to the erroneous foul call and thus the call did not affect the outcome of the play.

Reference: Casebook 2-16-1 Situation B

- 15. B7 swings at a pitch as R1 is stealing second base. B1 misses the ball and his bat comes completely around and strikes F2 in the shoulder with his bat as F2 was attempting a play on R1.
 - a. This is follow-through interference.
 - b. This is backswing interference.

Reference: 2-21-4 and 2-21-5

- 16. Team A lists Andrews as a CF/DH in the 1 spot of the lineup. In the 4th inning, Richardson substitutes as the center fielder. In the 7th inning, Andrews re-enters defensively in centerfield.
 - a. Legal. Andrews is entitled to re-enter on defense since he was a starter. The DH remains intact because Richardson never participated in an offensive role.
 - b. Illegal. A position player may not occupy two positions in a lineup.
 - c. Legal provided that Andrews was removed for concussion protocol. Richardson is now removed from the game.
 - d. Illegal. Andrews may not re-enter the game under any circumstance.

Reference: Rule 3-1-4-b

- 17. Team A is taking infield before the start of the game. Team B has gathered near their dugout and is making unsportsmanlike comments directed at Team A.

- a. The umpire shall issue a team warning for unsporting behavior to Team B and immediately eject the head coach.
- b. The umpire shall identify and eject a specific player seen making unsporting comments.
- c. The umpire shall warn the Team B's head coach that any additional unsporting comments or attempts to intimidate an opposing player will result in the immediate ejection of the offender.

Reference: Casebook 3-3-1 Situation J

18. During a pitching change, Team B's Head Coach stands behind the mound while the new pitcher is warming up. This coach proceeds back to his dugout as his pitcher concludes his warmup pitches.
- a. Legal, but Team B is charged a defensive conference
 - b. Illegal. Team B's Head Coach must return to his dugout once he has made a pitching change.
 - c. Legal provided that he does not discuss strategy with the other defensive players.
 - d. Legal provided that Team B's Head Coach leaves when such warmup pitches are complete and does not delay the game.

Reference: Casebook 3-4-1 Situation H and 2019 NFHS Interpretations Play #18

19. Team B's head coach visits his starting pitcher in the bottom of the 1st inning. The umpire goes to the mound to end the conference, but before he tells the coach the conference has ended the coach asks for maintenance to the mound. The umpire agrees that maintenance is needed and directs a maintenance crew to take care of the issue. That head coach never leaves the vicinity of the pitcher's mound and continues to talk to his pitcher after the mound is taken care of. The umpire returns to the mound and for the first time tells the coach he must end the visit.
- a. Do not charge Team B a defensive conference as this was for the purpose of field maintenance.
 - b. Charge Team B two defensive conferences as the coach conferred with players after the maintenance was complete.
 - c. Charge Team B only one defensive conference as the initial conference had never ended.
 - d. Charge Team B only one defensive conference, however the Team B head coach continued to talk to his pitcher after the maintenance finished and should be given an official warning.

Reference: Rule 3-4-3 and Casebook 3-4-3 Situation (a)

20. Jensen is listed as the DH in the #5 spot for the F1 Gonzalez. In the Bottom of the 2nd, Arruda pinch hits for Jensen. Jensen had not come to bat yet in the game and was not incapacitated for any other reason.
- a. Illegal. Jensen must bat at least one time unless he is injured or ejected from the contest.
 - b. Legal, but the DH is terminated from the game.
 - c. Illegal. Only Gonzalez may come to bat in that position.
 - d. Legal. Gonzalez remains as F1 and Arruda is now the DH.

Reference: Rule 3-1-4-a

21. F1 finished the bottom of the 4th inning defensively. In the bottom of the 5th inning, F1 does not come out of the dugout. Instead, S2 walks to the mound and picks up the game ball. S2's coach has not reported any substitution to the umpire. While on the mound and with the baseball in his hand before beginning his eight warm up pitches, S2's head coach tells him to return to the dugout, which S2 does immediately. F1 then goes to the mound and begins warming up.
- a. S2 must face one batter unless he becomes incapacitated or ejected. F1 is removed from the game and may not return to pitch in that game.
 - b. F1 may still pitch because S1 had not begun his warm-up pitches and was therefore not in the game. Had S1 thrown a warmup pitch, he would have been legally in the game.

- c. S2 must face one batter unless he becomes incapacitated or ejected. F1 may still be eligible to return under the re-entry rule.
- d. F1 may still pitch. S1 never entered the game because he had not been announced, nor was he an unannounced substitute because the ball had not become live while S1 was in contact with the pitcher's plate.

Reference: 3-1-1-b

22. A uniformed player is spotted behind the backstop operating a video camera.
- a. Legal if it was for an authorized purpose
 - b. Illegal. A coach, player, substitute, attendant or other bench personnel may not be outside the dugout or bullpen area unless he is a batter, runner, on-deck hitter or one of the nine defensive players. It would have been legal if the video camera was operated in the dugout.
 - c. Legal provided this player's head coach notifies on the lineup card that such player is not participating in the game and the umpire-in-chief approves such request.
 - d. Illegal. Videotaping outside of the dugout is not legal, whether the camera is attended or unattended.

Reference: Rule 3-3-1-i and Casebook 3-3-1 Situation OO

23. R3 is at third base. F1 has come to a legal stop while in the set position, then starts his motion to pitch. A player in Team A's dugout makes a disconcerting noise causing F1 to stop his pitching motion before releasing the pitch.
- a. This is a balk. R3 is awarded home. F1 is expected to complete his delivery without interruption or alteration in this situation.
 - b. This is not a balk. Team A committed actions for the sole purpose of causing a balk. The umpire shall warn for Team A and shall eject any future offender(s).
 - c. This is an illegal pitch. A ball is added to the batter's count and R3 remains at third base.
 - d. No balk and no pitch. Team A committed actions for the sole purpose of causing a balk. The offending player(s) shall be ejected.

Reference: Rule 3-3-1-n, Penalty

24. An umpire must always issue a verbal warning prior to ejecting a player or coach.
- a. Correct. The only accepted process is to first issue a verbal warning, then a written warning, and only then can a coach or player be ejected.
 - b. Not correct. An umpire must issue a verbal or written warning before any ejection, but both warning types are not required.
 - c. Not correct. Some conduct may be immediately judged by the umpire as major, and therefore an immediate ejection is warranted, whether warnings were previously given or not.

Reference: Rule 3-3-1f Penalty

25. B4, playing for Team A, unintentionally throws his bat and it strikes the catcher.
- a. It was careless, but it was judged to be unintentional, so there is no action required of the umpire.
 - b. It was careless, but it was judged to be unintentional. The umpire shall issue a warning to the head coach of Team A. Going forward, any player from Team A that carelessly throws a bat shall be ejected.
 - c. It was careless. Whether it was intentional or not doesn't matter. B4 is immediately ejected and the head coach for Team A is immediately restricted to the dugout.

Reference: Rule 3-3-1c Penalty

26. Team A is in a 9-player lineup with Jones serving as a P/DH in the fourth spot in the lineup. In the bottom of the 7th, Jones doubles to right. S1 Smith enters the game for Jones as a runner.
- Team A now has a 10-player lineup, with Jones remaining as the pitcher and S1 now the DH.
 - Team A still has a 9-player lineup, but has terminated the DH. Jones has left the game but can return. S1 Smith is now in the lineup in the fourth spot in the batting order.
 - Team A still has a 9-player lineup, but could switch to a 10-man lineup if the coach immediately informs the umpire Jones will continue to pitch and S1 Smith will be the DH.
 - Team A still has a 9-player lineup and S1 Smith becomes the P/DH. Jones is removed from the game but can return later in the game to be the P/DH.

Reference: Rule 3-1-4-b2 and Casebook 3-1-5 Situation H

27. After using all available charged defensive conferences, Team B's head coach goes to the mound and moves F1 to left field and brings F9 in to pitch. Which of the following are true?
- F1 may return to pitch once during that inning
 - F1 may not return to pitch
 - F1 has not been removed from the game
 - Both B and C

Reference: Rule 3-4-1 Penalty

28. B1 enters the batter's box with an illegal bat. This is the first violation of the game.
- The batter is restricted to the dugout for the remainder of the game.
 - The batter is declared out.
 - The batter is ejected.
 - The head coach is warned and restricted to the dugout for the remainder of the game.
 - The head coach is ejected.
 - A and D
 - B and D
 - B and E

Reference: Rules 1-3-5, 4-1-3b Penalty, and 7-4-1a

29. Each team's lineup card shall list a minimum of nine players to start the game and can finish with eight players.
- True
 - False

Reference: Rules 4-1-3 and 4-4-1f

30. If a team is down to playing with eight players, it can later play with nine if an eligible player is found.
- True
 - False

Reference: 4-4-1f NOTE 2

31. Before the first game of a double header, both varsity head coaches agree that due to impending weather, both games would be five inning games.
- Legal. As long as both coaches agree prior to the beginning of the first game and inform the umpires.
 - Legal. Both coaches can agree at any time to shorten, even if the umpire in chief does not agree.
 - Not legal. By NFHS Baseball Rules Book, if playing a double header one game must be a seven-inning game. The second game can be five innings.

- d. Not legal. A regulation varsity game consists of seven innings. Coaches cannot agree to shorten a game in advance, but can agree to end a game at any time after it starts as long as the umpire in chief agrees.

Reference: Rules 4-2-1 and 4-2-4, Casebook plays 4-2-4 Situation A and Situation B

32. When playing with eight players, an out will be called each time the empty spot in the batting order is due to bat.
- a. True
 - b. False

Reference: 4-4-1 NOTE 1

33. Team A and Team B are scheduled to play a doubleheader. The night before the games are to be played there was rain. Who determines whether the condition of the grounds and field are suitable for play?
- a. Both coaches must agree with the condition of the field prior to both games being played.
 - b. Only the home team head coach shall decide whether the grounds and other conditions are suitable to start the game(s).
 - c. The home team head coach shall decide whether the grounds and other conditions are suitable for starting the game. After the game starts, the umpires are the sole judges as to whether conditions are fit to play and as to whether or not conditions are suitable for starting the second game of a scheduled double header.

Reference: Rule 4-1-1

34. The game will not begin until both head coaches verify to the umpire-in-chief that all participants are legally and properly equipped.
- a. True
 - b. False

Reference: Rule 4-1-third base

35. The opposing coaches submit their lineups to the umpire-in-chief. However, not all the players of the visiting team are at the field. The coach lists the players not at the game as the eighth and ninth hitters to give them time to arrive.
- a. This is legal if the opposing team head coach agrees.
 - b. If agreed by both coaches, when the eighth and ninth batter comes to bat and the ninth batter has not arrived yet, an out will be called on each of them.
 - c. This is not allowed. At the time the lineups are exchanged, all starters must be at the field. Therefore, the coach of the visiting team must replace the players not at the game. If the coach does not have enough players to start the game, it is ruled a no contest.

Reference: Casebook 4-4-1 Situation E

36. B1 hits a ball sharply straight down near his feet. The plate umpire judges the ball did not strike B1 and allows play to continue and makes a safe signal to communicate he judged the ball did not touch the batter. U1 believes the ball struck B1's foot and immediately signals and declares the ball foul. B1 continues running to 1B, and F5 fields the bounding ball in fair territory and throws to F3 for what he believes is a force out of B1.
- a. U1's foul call is ignored, as the primary calling responsibility belonged to the plate umpire and U1 cannot overrule the initial call. B1 is out.
 - b. U1's foul call stands. Although the plate umpire did make the initial judgement that the ball did not strike the batter, once any umpire declares the ball foul, the call cannot be reversed.

Reference: Rule 5-1-h

37. R1 on 1B, R3 on 3B and B4 at the plate with a 1-0 count and no outs. R1 attempts to steal on the pitch. B4 swings and misses, and his momentum carries him across the plate, where he lightly collides with F2 as F2 is attempting to throw to 2B to make a play on R1. The plate umpire judges B4's actions as interference and allows play to continue. F2's throw to F6 is late and R1 is safe at 2B. R3 attempts to steal home when the throw goes to 2B. F6 throws home and R3 is tagged by F2 before touching the plate.
- R1 is out for interference and R3 is out on the tag play at the plate.
 - R1 is safe at 2B and R3 is out on the tag play at the plate.
 - The defensive coach has the option to take the interference penalty or the result of the play.
 - Once R1 was not retired on the throw, the ball is dead. B1 is declared out for interference, R1 is returned to 1B, and R3 is returned to 3B.

Reference: Rule 5-1-2(a)(1)

38. With the bases loaded and 1 out the batter swings at a pitch and F2 obstructs his swing. The batter still strikes the ball and hits a high fly ball to F3. The umpires invoke the infield fly rule. The ball is caught.
- BR is out all base runners may advance at their own peril
 - Obstruction is called and BR is awarded first base and all runners are awarded one base from the time of the pitch.
 - The Batter is out on the caught ball all runners are awarded one base due to obstruction.
 - The umpire shall call time and bring the batter back to the plate and declare no pitch.

Reference: Rule 8-1-1

39. With a runner on first and third, F1 attempts a pick off to first base. R1 dives back into 1st base safely. A member of F1's team in the first base dugout throws a ball against the dugout fence. Thinking there is an over-throw R1 takes off for second base where he is easily put out.
- This is obstruction R1 shall be awarded 2nd base. R3 shall remain at 3rd base. The offender shall be warned.
 - R1 is out.
 - This is obstruction R1 should be awarded 2nd base. No further penalty.
 - This is obstruction R1 should be awarded 2nd base. R3 should be awarded home.

Reference: Rule 3-3-1-F and 8-3-2



40.

- a. Legal in both. The fielder may block a base when there is potential for a play.
- b. Legal in both. The fielders are blocking a part of the base, but not all of it. The runners still have a portion of the base to try for.
- c. Obstruction. The fielders are blocking the bag without secure possession of the ball.

Reference: Rules 2-22-3 and 8-3-2

41. R2 and R3 with two outs. The pitcher, in his delivery, pushes completely off the pitcher's plate and releases the pitch while his pivot foot is clearly and completely in the air and in front of the pitcher's plate. B5 hits the pitch for a double. You are the plate umpire.
- a. Play stands. R2 and R3 score. B5 is on second with 2 outs.
 - b. This is a balk. Award R3 home, R2 third base, and B5 returns to bat with the same count.
 - c. Call a balk, but since the BR and all other runners advanced at least one base, the balk is not enforced.
 - d. Call batter's interference for the third out of the inning and no runs score.

Reference: Rules 6-1-1, 6-1-2, 6-1-3 Penalty and NFHS 2020 Interpretations Play #16

42. B1 is batting with an 0-0 count and the bases loaded. F1 is in the wind up position with the ball in his bare hand down by his side and his empty glove down by his other side. After getting the sign, F1 begins his pitching motion by now bringing his ball hand and glove together in front of him and stops for one second in this position. F1 then continues his windup and delivers the pitch, which is taken for a called ball.
- a. This is a legal play. Bases remain loaded and the count is now 0-1.
 - b. This is a balk because the pitcher started and then stopped his delivery. Award R3 home on the balk and all other runners are awarded one base. The count is now 1-0.
 - c. This is a balk because the pitcher started and then stopped his delivery. Award R3 home and all other runners one base. Count remains at 0-0.
 - d. None of the above are correct.

Reference: Rule 6-1-1, 6-1-2, 6-1-3

43. B3 is batting with a 3-1 count and no runners on base. While legally in contact with the pitcher's plate, F1 reaches for the baseball in his glove but then drops the ball. F1 retrieves the ball before it crosses a foul line.
- a. Illegal pitch. Add a ball to the count and B1 is then awarded first base because the awarded ball was Ball 4.
 - b. This is a balk. A ball is awarded to B1, and he is then awarded first base because the awarded ball was Ball 4.
 - c. No pitch. Count remains 3-1.
 - d. Illegal pitch. Count remains 3-1.

Reference: Rule 6-1-4

44. B1 batting with a 3-2 count and no runners on. After his previous pitch, F1 now varies the speed of his delivery from the windup position on this pitch by taking less time between the pitches and speeding up his pitching motion. On the next pitch B1 swings and misses. The umpire judges B1 was not off-balance and was ready to hit.
- a. Illegal pitch and add a ball to the count, resulting in awarding B1 first base on ball four.
 - b. Illegal pitch and the count remains 3-2
 - c. No pitch and the count remains 3-2
 - d. The play stands and the inning is over. A pitcher may vary his timing and speed of delivery as long as the umpire judges the batter was ready to hit the pitch.

Reference: Rule 6-1-1

45. R2 at 2B. F1 is on the mound but not in contact with the pitcher's plate when he takes a sign from the dugout. F1 then steps onto the pitcher's plate in a stretch position and brings his hands together, looking at R2. F1 pauses very briefly while looking at R2, then turns his head towards the plate for the first time while simultaneously starting his pitching motion.
- Balk. F1 did not take, or at least simulate taking a sign from the catcher.
 - Legal. F1 paused briefly with his hands together before starting his pitching motion.

Reference: Rule 6-1-1

46. F1, a left-handed pitcher, is using the set position. The heel of F1's left foot is in contact with the 1B edge of the pitcher's plate, and his toe is outside the line of the pitcher's plate. F1's right foot is in front of and parallel to the pitcher's plate.
- F1 is in a legal set position
 - F1 is in a legal windup position
 - F1 is in an illegal hybrid position.

Reference: Rule 6-1-2

47. R3 and no count on B4. F1's pivot foot is in contact with the pitcher's plate. F1 adjusts his cap as he is taking signs from the catcher and prior to bringing his hands together in a set pitching position. F1 then delivers the pitch after legally coming set and B4 fouls off the pitch.
- Legal. R3 remains at third base and B1 now has an 0-1 count
 - Illegal Pitch. R3 remains at third base and the foul ball is nullified. A ball is awarded to B1, and the count is now 1-0.
 - Balk. R3 is awarded home and the foul ball is nullified. A ball is awarded to B1, and the count is now 1-0.

Reference: Casebook 6-1-2 Situation D

48. B1 is batting with an 0-0 count with R1 on first base and R3 on third base. Left-handed F1 is in a set position and legally pauses. F1 then attempts to pick R1 off at first base. F1's entire non-pivot foot completely clears the vertical plane of the rear of pitcher's plate before F1 clearly steps then throws towards F3 at first base. The throw is wild. R3 scores and R1 gets to third base without a play.
- Legal. R1 remains at third base and R3 scores.
 - Balk. The head coach of the offense can take the results of the play or ask for the balk penalty to be applied.
 - C. Illegal pitch. R3 remains at third base, R1 remains at first base, and a ball is added to the batter's count.
 - Balk. R3 is awarded home, R1 is awarded second base, and B1 remains at bat with an 0-0 count. The offense does not get an option on the play.

Reference: Rule 6-2-4-f

49. Pitcher F1 is wearing a black solid-colored wristband on his glove-side arm for the purpose of taking signs from either the dugout or his catcher. Legal?
- Not Legal, F1 cannot wear a wristband for any purpose while pitching
 - Not Legal, F1 has to wear that on his belt if he elects to use it
 - Legal provided that the head coach notified the plate umpire prior to the plate meeting
 - Legal provided that such wristband is not deemed to be distracting by the umpire

References: Rule 1-4-2, 1-5-9, and 6-2-1-f Penalty & 2019 NFHS Interpretation #17

50. R1, 1 out, 2-1 Count; F1 takes the set position with his pivot foot entirely in parallel and in contact with the front edge of the pitcher's plate. F1's non-pivot foot is entirely in front of his pivot foot (towards home plate) but is not completely within the plane of each end of the pitcher's plate. F1 then delivers a called strike.
- Balk
 - Legal
 - Illegal Pitch

Reference: Casebook 6-1-3 Situation A

51. R2, R3, 2 outs, 1-1 count; While the ball is live, F1 is tying his left shoe approximately 4' away from the pitcher's plate without the ball. F6 has the ball in his glove while F1 is tying his shoe. R2, unaware F6 has the ball, steps off second base and is tagged by F6 while off the base.
- This is a balk. R3 is awarded home, and R2 is awarded third base. B1 remains at bat with a 1-1 count and two outs.
 - Legal. R2 is out and the inning is over
 - This is nothing. The ball is dead because F1 was tying his shoe, and time out is declared automatically when a player is correcting an equipment issue. R2 remains at second base, R3 remains at third base, and B1 continues with a 1-1 count with two outs.
 - Unsporting Conduct. R3 remains at third base, R2 remains at second base, B1 remains at bat with a 1-1 count and two outs. F1 and his team receive a warning for unsporting behavior.

Reference: Rule 6-2-5

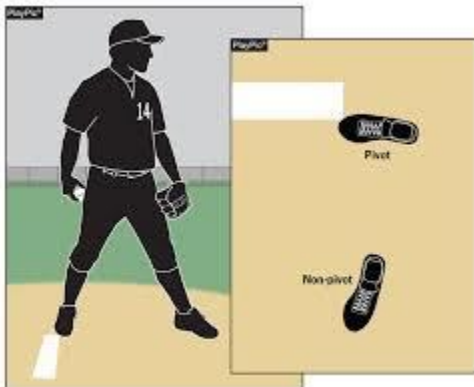

- 52.
- Legal set position
 - Legal windup position
 - Illegal

Reference: Rule 6-1-2

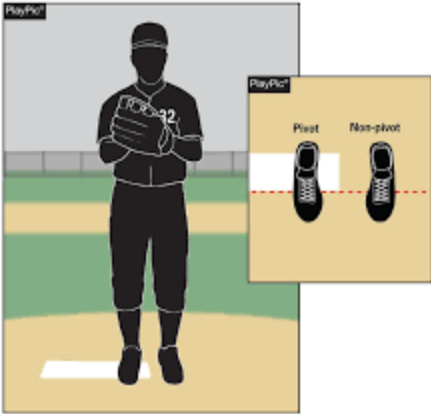

- 53.
- Legal set position
 - Legal windup position
 - Illegal

Reference: Rule 6-1-3

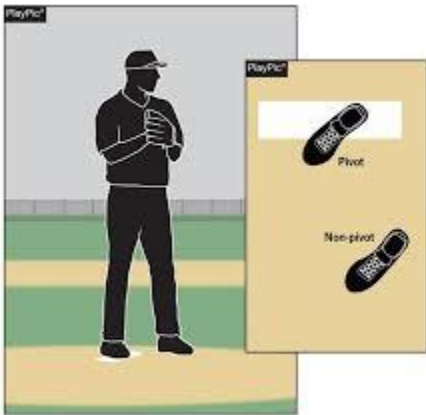

- 54.
- Legal set position
 - Legal windup position
 - Illegal

Reference: Rule 6-1-1

55. B1 is at bat with 1 out and a count of two balls and two strikes and R1 on first base. R1 steals on the pitch. B1 swings and misses but the ball then hits B1 on his arm. No play is made on R1 at second base.
- Call B1 out on interference and since R1 was stealing, he is allowed to stay at second
 - Call B1 out on strike three and since R1 was stealing, he is allowed to stay at second.
 - Call B1 out on strike three and call out R1
 - Call time when the ball hits B1, call out B1 on strike three, return R1 to first base.
 - Call time when the ball hits B1, call out B1 on strike three, allow R1 to remain on second.

Reference: Casebook 7.3.4 Situation A

56. With R2 on second base, B1 is batting with a 1-1 count and no outs. B1 hits a high pop up in foul territory just beyond first base. B1's first base coach clearly tries to get out of F3's way but still contacts him and hinders his attempt to catch the ball. The umpire judges the contact between the base coach unintentional.
- This is interference. R2 is declared out and B1 resumes batting with a 1-2 count.
 - This is interference. B1 is declared out and R2 is awarded third base.

- c. This is interference. B1 is declared out and R2 remains at second base.
- d. Legal. R2 remains at second base and B1 resumes his at-bat with a 1-2 count.
- e. None of these answers are correct

Reference: Casebook 7.4.1 Situation H

57. R1 is on first base and B7 is the next batter in the batting order, but B8 comes up to bat instead of B7. With the count 2 balls and 2 strikes and one out, R1 steals second base. B8 walks on the next pitch. Before the pitch to the next batter, the head coach comes to the plate umpire and says that B8 batted out of order.
- a. Declare B8 for batting out of order and remove him from first base. R1 is returned to first base, which is where he was when B8 started his improper at-bat. B9 now starts his at-bat.
 - b. Declare B7 out for failing to bat. R2 remains at second base because he reached second base unrelated to anything B8 when he was batting. B8 is removed from first base and now starts his at-bat.
 - c. Declare B7 out for failing to bat and declare B8 out for batting out of order, ending the inning.
 - d. Declare B7 out for failing to bat. All other play stands. R1 remains at second base and B8 remains at first base, now with two outs. B9 starts his at-bat.

Reference: Rule 7.1.1 and Casebook 7-1-1 Situations A and D

58. B5 is batting instead of the proper batter B4 with R3 on third base. With a 2-2 count and two outs, B5 swings at the next pitch and misses. F2 does not catch the ball and B5 runs to first base due to the dropped third strike. F2 throws to F3, but B5 is called out. R3 touches the plate before B5 is thrown out. Before the next pitch to B6, the head coach comes to the plate umpire and says that B5 batted out of order.
- a. Declare B4 out for failing to bat. R3's run counts as his advancement was only due to the play remaining live because of an uncaught 3rd strike and he touched the plate before the last out was recorded.
 - b. Declare B5 out for batting out of order. R3's run is nullified.
 - c. B4 is declared out for failing to bat. Since the third out was made by the batter-runner, who technically did not reach first base, R3's run does not count. B5 is the batter to start the next inning.
 - d. B5's is out is the last out of the inning, so no batting out of order appeal is allowed. Since the third out was made by the batter-runner, who technically did not reach first base, R3's run does not count. B6 is the batter to start the next inning.

Reference: Casebook 7.1.2 Situation B

59. B1 is batting with one out and a count of 2-1 and R1 on first base. R1 takes off for second base as the pitch is released. B1 swings at the pitch and fouls the ball straight back into the screen. When B1's bat contacted the ball B1's foot was partially in the batter's box and in contact with the plate.
- a. Illegally batted ball. The ball is immediately dead. B1 is declared out and R1 is returned to first base.
 - b. Foul ball because it was hit foul. B1 continues his at-bat with a count of 2-2 and R1 is returned to first base.
 - c. Foul ball because B1 was in contact with the plate. R1 is returned to first base, and B1 continues his at-bat with a 2-2 count.
 - d. Foul ball because B1's foot was still partially in the batter's box. His foot being in partial contact with the plate is irrelevant. B1 continues his at-bat with a 2-2 count and R1 is returned to first base.

Reference: Casebook 7-3-2 Situation D

60. B3 batting with a 2-1 count and one out. R2 on second base. As F1 begins his pitching motion, R2 attempts to steal third base. B3 swings at the pitch and misses. B3's momentum carries him across the plate and makes contact with F2 at the same time F2 was trying to make a throw to third and make a play on R2. The ball thrown by F2 bounces twice before getting to third base, and R2 is standing on third before the ball arrives.

- a. This is interference. The plate umpire shall declare the interference and call time immediately. R2 is declared out and B3 continues his at-bat with a 2-2 count.
- b. This is interference. The plate umpire should immediately point at the batter and announce the interference and let play continue. Since R3 was not tagged out on this particular play, the interference is enforced. Since there were less than two outs at the time of the interference, B3 is declared out and R2 is returned to second base.
- c. This is interference. The plate umpire should immediately point at the batter and announce the interference and let play continue. Since R3 was not tagged out on this particular play, the interference is enforced. R2, as the runner being played on, is declared out and B3 continues his at-bat with a 2-2 count.
- d. This may or may not be interference. If the plate umpire judges R2 would have been safe anyway, the interference is cancelled.

Reference: Rule 7-3-5 and Casebook 7-3-5 Situation B

61. B2 is batting with one out and a count of 2-1. R2 is at second base. R2 attempts to steal third on the pitch. B2, who bats right-handed, after (a) swinging OR (b) not swinging at the pitch is still completely in his batter's box. In (a), B2 remains completely within the batter's box and does not contact F2 with his bat, and in (b) stays completely still and completely within the batter's box, not having time to do anything else. In both (a) and (b) F2 tries to throw to third to make a play on R2, but in both cases F2's throw hits B2 and deflects away. R2 gets to third base without any additional play.
- a. In both (a) and (b) it is interference. The batter must make an attempt to get out of the way of F2.
 - b. It is interference in (a), but not (b).
 - c. It is interference in (b), but not (a).
 - d. The batter is legal in both (a) and (b)

Reference: Rule 7-3-5-d and Casebook 7-3-5 Situation E

62. B6 is batting right-handed and has a 1-1 count with R3 at third base and one out. As the pitch is released, R3 breaks for home and B6 squares to bunt. B6 misses the bunt and unintentionally but clearly interferes with F2's attempt to tag out R3, who slides across the plate untagged.
- a. Legal play since the contact was unintentional. R3 scores and B6 continues his at-bat with a 1-2 count.
 - b. This is interference on B6. B6 is declared out and R3 scores.
 - c. This is interference on B6. B6 is declared out and R3 is returned to third.
 - d. This is interference on B6. R3 is declared out and B6 continues his at-bat with 1-2 count. The penalty would have been different if the interference had happened with two outs.

Reference: Rule 7-3-5 and Casebook 7-3-5 Situation C

63. R1 at 1B, B2 batting is a 1-0 count. F1 delivers a pitch that B2 swings at and misses. B2's bat comes completely around and strikes F2's glove, causing the ball to drop from his glove and roll away from him. R1 sees this and starts running to 2B and makes it without a play.
- a. This is interference. A batter is responsible for his bat. B2 is declared out, and R1 is returned to 1B.
 - b. This is interference. R1 is declared out and B2 continues to bat with a 1-1 count.
 - c. This is a legal play as long as the umpire judges B1's contact with F2 as unintentional. R1 remains at 2B and B2 continues to bat with a 1-1 count.
 - d. This is follow-through interference. The ball is dead as soon as the umpire judges no play will be attempted on R1. B2 is declared out for follow-through interference and R1 is returned to 1B.

Reference: Rulebook 2-21-4 and 7-3-5c

64. There are two outs and B2 has a count of 0-2. R1 is on first base and breaks for second base on the next pitch. B2 swings and misses the 0-2 pitch, which is not caught by F2. B2 runs to first base and makes it without a play. The defensive coach says B2 is out on the uncaught third strike because first base was occupied at the time of the pitch.
- B2 is out for the swinging strike three because R1 occupied first base at the time of the pitch. It does not matter if F2 threw the ball or not and the inning is over.
 - B2 can legally try to run from the plate to first base on this play, even though R1 started on first base, because there were already two outs.
 - B2 can legally try to run from the plate to first base on this play because R2 was attempting to steal on the play and therefore first base was considered not occupied at the time of the pitch.

Reference: Casebook 7-4-1 Situation A

65. R2 at 2B, B4 batting with one out. F1 delivers a pitch that B4 swings at. During the swing B4's bat lightly strikes F2's glove as F2 is reaching for the incoming pitch. Nonetheless, B4 hits the ball into center field for a base hit. The umpire signals and announces the obstruction by F2 and allows play to continue. R2 rounds third and attempts to score and is thrown out the plate. B4 is then thrown out try to advance to 2B. After all play has stopped the offensive head coach tells the umpire he has an option to take the results of the play or the penalty, and says he wants the penalty applied instead of the results of the play.
- The coach is correct. R2 is returned to 2B and B4 is awarded 1B and there is one out.
 - The coach is correct. R2 is placed at 3B based on the judgement of the umpire that he would have made it there safely had there not been obstructions by F2. B4 is awarded 1B and there is one out.
 - The coach is not correct. No option is given because catcher's obstruction is ignored because R2 made it at least one base safely, and B4 also made it at least one base safely. That they were both later called out attempting to advance to additional bases doesn't mean that an option is available to the offense anymore. Both outs stand and the half-inning is over.

Reference: Rule 8-1-1e

66. With R2 on second base, B4 swings at a pitch. B4's bat touches F2's glove on the initial swing as F2 reached out to catch the pitch. B4 still makes contact and hits a ground ball to F1. F1 throws to first and B4 is out on the force play. Meanwhile, R2, running on the play, is put out after over sliding third base. R2 was not stealing.
- Legal play. Both outs stand.
 - Interference. BR is out and R2 is returned to 2nd base
 - Defensive obstruction. BR is awarded 1B. R2 is awarded 3B since he attempted to advance on the play.
 - Defensive obstruction. BR is awarded 1st base R2 is retired since he advanced at his own peril
 - Defensive obstruction. BR is awarded 1st base R2 is returned to 2nd since he was not stealing on the pitch

Reference: Casebook 8.1.1 Situation M

67. With a runner on second base F2 obstructs the batter's swing. The batter is put out at first and R2 is put out after over sliding third base. R2 was stealing on the pitch.
- Legal play. Both outs stand.
 - Interference. BR is out and R2 is returned to 2nd base
 - Defensive obstruction. BR is awarded 1B. R2 is awarded 3B since he attempted to advance on the play.
 - Defensive obstruction. BR is awarded 1st base R2 is retired since he advanced at his own peril.
 - Defensive obstruction. BR is awarded 1st base R2 is awarded 3rd since he was stealing on the pitch.

Reference: Casebook 8.1.1 Situation M

68. While in the act of fielding an errant throw from F8, F2 takes 2-3 steps up the third base line and hinders R3's ability to safely touch home. There is contact between R3 and F2.
- R3 is out
 - R3 is returned to third base
 - R3 shall be out and warned for making contact with the catcher
 - R3 is awarded home
 - B and C
 - C and D

Reference: Rule 8-3-2 and casebook 8-3-2 Situation C

69. R1 attempts a steal of second base. Given R1 got a good jump and will easily be safe F2 does not attempt a throw. F6 fakes a tag when R1 is approximately 15 feet away from the base. R1 then goes into a slide into the base, even though no throw was made to F6.
- R1 is awarded third base due to obstruction
 - R1 is awarded second base. Umpire shall call time and warn the defensive coach.
 - R1 is awarded third base due to obstruction umpire shall warn the defensive coach.
 - R1 is awarded second base. F6 is ejected for the dangerous fake tag.

Reference: Casebook 8.3.2 Situation E

70. R1 attempts a steal of second. F2 overthrows F6 and the ball ends up in center field. F6 fakes a tag when R1 is approximately 15 feet from the bag. R1 slides to avoid the tag as the throw goes into the outfield.
- R1 is automatically awarded third base due to obstruction.
 - R1 is automatically awarded second base. Umpire shall call time and warn the defensive coach.
 - R1 is automatically awarded third base due to obstruction and the umpire shall warn the defensive coach.
 - R1 is automatically awarded second base and F6 is ejected for the dangerous fake tag.
 - If the umpire judges that R1 would have been able to obtain 3rd or home due to the over-throw he can award R1 the base he would have made had he not been obstructed.

Reference: Casebook 8.3.2 Situation E

71. F1 attempts to pick off R2. Once he has possession of the ball F6 drops his knee and completely blocks second base and tags R2 out.
- Obstruction. R2 is awarded third base
 - Obstruction. Since R2 was diving back to second base he stays at second
 - Legal. R2 is out. Because F6 had possession of the ball, he could legally block the base.

Reference: Casebook 8.3.2 Situation G

72. R1 on 1B. F1 attempts to pick R1 off and a rundown between 1B and 2B ensues. As R1 is running towards 1B the ball becomes lodged in F3's shirt. (*ball is lodged in a runner's shirt*)
- Play on. A lodged ball is only an issue when it involves the catcher or umpire.
 - The ball is dead as soon as it becomes lodged. R1 is awarded 2B.
 - The ball is dead as soon as it becomes lodged. R1 is awarded 1B.

Reference: Rule 8-3-3-f

73. R1 on 1B. F1 attempts to pick R1 off and a rundown between 1B and 2B ensues. As R1 is running towards 2B the ball becomes lodged in R1's shirt. (*Ball is lodged in a fielder's shirt*)

- a. Play on. A lodged ball is only an issue when it involves the catcher or umpire.
- b. The ball is dead as soon as it becomes lodged. R1 is awarded 3B.
- c. The ball is dead as soon as it becomes lodged. R1 is awarded 1B.

Reference: Rule 8-3-3-c

74. With R1 and R2 and 1 out and a count of 1-1, B5 hits a high pop-up near the bag at first base. Infield fly is declared. As F3 is tracking the ball, R1 bumps into him on his way back to the bag. U1 calls interference. (A) The ball is caught by F3 in fair territory; (B) The ball is caught by F3 in foul territory. R1 is properly called out for interference, but what happens to the BR?
- a. In A, the BR is out because the ball was caught.
 - b. In A, the BR is out on the infield fly.
 - c. In B, the BR is out because the ball was caught.
 - d. In B, the BR is returned to bat with a 1-2 count because the ball was in foul territory, therefore, no infield fly rule applied.
 - e. A & C
 - f. B & D

Reference: Rule 8-4-2g

75. B1 hits a fair ball in front of home plate. Both the batter-runner and catcher make contact while trying to complete their respective responsibilities.
- a. The catcher has the right to field the batted ball; this is interference.
 - b. The runner has the right to the baseline; this is obstruction.
 - c. This is neither interference nor obstruction if neither player attempts to alter the play.

Reference: Rule 8.1.1 Situation R

76. With R1 and no outs, B1 hits a ground ball towards the second baseman. The pitcher deflects the ball and while F4 is attempting to field the ball, R1 unintentionally runs into F4. What is the correct ruling?
- a. This is nothing because the ball was touched by F1.
 - b. This is nothing because there was no intent.
 - c. This is obstruction on F4. Once the ball was touched by F1, the defense must give way to all runners.
 - d. This is interference by R1. Even though the ball was deflected by F1, the runner must not hinder or impede a fielder who is making a play on a batted ball.

Reference: Rule 8-4-2g

77. With R2 and 1 out, B3 hits a ground ball towards F6. The pitcher reaches out and deflects the ball which then hits R2 in the foot. There was no intent by R2 to get hit by the batted ball.
- a. R2 has not committed an infraction since getting hit by the ball was unintentional.
 - b. This is interference by R2 and he is out. Place the BR at first base.
 - c. This is interference by R2 and both he and the BR are out.

Reference: Rule 8-4-2k

78. With R1 and no outs, F3 is playing in towards the plate in anticipation of a bunt. B9 hits a ground ball which hits R1 behind F3. R1 did not intentionally allow himself to be hit by the ball.
- a. Since the ball has passed F3, R1 is not out in any case.
 - b. Even though the ball passed F3, if F4 was able to make a play on the ball, then R1 is out.
 - c. If a double play was possible, then R1 and the BR are both out.
 - d. The BR is also out only if F3 allowed himself to be hit with the ball intentionally.

e. B & C

Reference: Rule 8-4-2k

79. With R1 and no outs and R1 stealing on the pitch, B2 hits a ground ball to F6 who throws to F4 at 2nd base to attempt to put out R1. The throw arrives after R1 touches second base. R1 slides into F4, who is on the third base side of the bag, but R1 can reach 2B with his hand. F4 attempts to throw to 1st base to retire the BR but is unable to complete the play because of R1 sliding into him.
- The play stands. Because R1 beat the play and was safe, there is no force play infraction.
 - Even though R1 beat the throw at 2B, he is out for interference and the batter runner is awarded 1B.
 - This is interference on force play. Both R1 and the BR are out, even though R1 beat the throw to 2B.
 - None of the above.

Reference: Rule 8-4-2b

80. With R1 and no outs, B3 hits a hard ground ball to F6. As R1 approaches second and is 8 feet from the base, he does not slide but goes in standing up, straight in towards the bag. F4 is on the bag and pivots to make the throw to first to retire the BR but hesitates and the throw to first is late.
- Runners are never required to slide, so there is no violation. R1 is out on the force play, and the BR is safe at first.
 - While R1 is not required to slide, if he chooses not to slide, he also cannot alter the play. This is interference on a force play and both R1 and the BR are out. R1 is out on the force play, and the BR is out for R1's interference.
 - R1 is far enough from the bag that he is not expected to slide, so there is no violation. R1 is out on the force play, and the BR is safe at first.

Reference: Rules 8-4-2b and 8-4-2f

81. R3 at 3B and R2 at 2B and no outs. B6 hits a fly ball to right field that is caught for an out by F9. R3 and R2 both return to their starting bases to retouch before advancing on the play. R2 waits until F9 touches the ball before leaving 2B, but R3 leaves his base before F9 touches the ball and scores without a play. Time is called. During the timeout there is no appeal of R3 leaving early. Once the ball is put in play by the umpire, R2, who is now on 3B, sprints for home and gets into a rundown, and is eventually tagged out. The defense then makes a live ball appeal that R3 left 3B early before the timeout and the rundown.
- The appeal is denied. The defense cannot make a live ball appeal once time has been called.
 - The appeal is denied. Once the defense started to make a play on R2 as part of the rundown, they could no longer make an appeal play on R3. The defense could have avoided this by making a dead ball appeal before the offense had an opportunity get the defense involved in a play.
 - The appeal is upheld and R3 is declared out for leaving 3B early.

Reference: Rule 8-2-5

82. No runners on base. B1 hits a ground ball to F5, who fields the ball and throws to F3. The throw is offline and F3 comes off of 1B and into B1's path to catch the ball. B1 collides with F3 just before F3 catches the ball. F3 does catch the ball and tags B1 before B1 touches 1B
- B1 is out on the tag. Although there was contact before F3 had possession of the ball, the contact occurred while F3 was attempting to field a thrown ball. This is commonly referred to as a "train wreck" and is one of the exceptions to the obstruction rule.
 - B1 is declared out for interference. B1 is required to allow F3 to field a thrown ball.
 - This is obstruction by F3. B1 is awarded 1B.

Reference: Casebook 8-3-2k

83. With R1 and no outs, B3 hits a ground ball to F4 who throws to F6 to start the attempted double-play. F6 receives the throw on the bag and is still on the bag when R1 slides directly into and through the base. There was no malicious contact and R1's foot was below the knee.
- Because R1 slid through the bag, this is a force play slide violation. R1 and the BR are out.
 - This is a legal slide. Even though R1 ended up past the bag, F6 was on the bag at the time R1 first contacted him and since the slide was otherwise legal, there is no infraction.
 - This is malicious contact by rule. R1 is out and ejected.

Reference: Rules 8-4-2b(2) and 2-32-2c



- 84.
- The batter is out for interfering with the catcher.
 - This is catcher's obstruction. The offense gets an option to take the results of the play or the penalty for the obstruction if the batter and all runners did not advance at least one base on the play.

Reference: Rule 8-1-1e

85. Bases loaded and two outs. B1 hits an uncaught fly ball to center field that rolls to the wall. B1 and all baserunners cross the plate. The defense successfully appeals that the runner that started at second base failed to touch the third base.
- No runs score because the appeal was successful at a base R2 was forced to.
 - R3, R1, and B1 all score and R2 is declared out on the appeal.
 - R3 scores because he was in front of the runner called out on appeal. R1 and B1 do not score because they trailed the runner called out on appeal for the third out of the inning.

Reference: 9-1 Exception d

86. Bases loaded in the bottom of the 7th inning. The game is tied. F1 delivers four balls to B5.
- The umpire(s) immediately declare the game over and leave the field.
 - The umpires declare the game over and leave the field as soon as R3 touches the plate for the walk-off run.
 - The umpires declare the game over and leaves the field as soon as all runners have touched the bases they were forced to by the base on balls.

Reference: 9-1 Note 2

87. The Points of Emphasis for this season include:
- Excessive Celebration / Proper Use of Equipment / Sitting On Buckets / Lodged Ball Procedure / Sportsmanship
 - Proper Pitching Positions / Legal Field Dimensions / Balks / Field Decorum

- c. Hybrid Pitching Stance / Game Ending Procedures / Designated Hitter Rule / Game Protest Procedures

Reference: NFHS Bulletin

88. If a team protests the game due to an alleged pitch count violation, it is the responsibility of the umpire to immediately resolve the protest on the field.
- True
 - False

NOTE: CIF-SS Blue Book, Article 150

89. Adult base coaches must wear a protective helmet, and the helmet must meet NOCSAE standards.
- True
 - False

NOTE: CIF-SS Blue Book, Article 150

90. No level of high school baseball has a time limit.
- True
 - False

NOTE: CIF-SS Blue Book, Article 150

91. On fly balls near the line, the calling umpire should signal catch/no catch first, then fair/foul second.
- True
 - False

92. Two-umpire system, two outs, and R1 at 1B. B4 hits a fly ball near the RF line that ultimately falls, uncaught, into fair territory. The base umpire should be ready to take a call at 3B if R1 attempts to go to 3B.
- True
 - False

93. Following an ejection in the two-umpire system, the non-ejecting umpire should stay away from any post-ejection confrontation to maintain a neutral impression.
- True
 - False

94. Umpires should check bats, helmets, and catcher's gear before each game to determine if they are legal.
- True
 - False

95. Wearing of cream shirts is acceptable if all umpires have the same style of shirt.
- True
 - False

96. In the two-umpire system and bases loaded, the base umpire has responsibility for all tag ups on a fly ball to center field.
- True
 - False

97. It is proper for a plate umpire to direct the catcher to adjust his stance or position so that the umpire's view of the strike zone is not blocked or hindered.
- True
 - False
98. It is recommended that the plate umpire record substitutions and conferences in between innings to avoid delaying the game.
- True
 - False
99. Two-umpire system with runners at 1B and 3B. A rundown develops between 3B and home. The base umpire should move in to take the 3B end of the rundown.
- True
 - False
100. There is no value to having a post-game if the game itself has no warnings issued or ejections.
- True
 - False
101. Obvious safe and out calls on the bases do not need the calling umpire to make a signal.
- True
 - False
102. Anticipating and making a call quickly makes good sense if the calling umpire needs move to another area of the field for another potential play.
- True
 - False
103. It is recommended the plate umpire carry a copy of the NFHS designated hitter rule in his ball bag or pocket during the game.
- True
 - False
104. On a force-play slide into second, the plate umpire assumes primary responsibility to watch and rule on potential interference by the runner at second base following the release of the throw to first base.
- True
 - False
105. In the two-umpire system with runners at 2B and 3B and a ground ball to the infield, the plate umpire should always move to the 1B line extended.
- True
 - False
106. With runners on first and third or bases loaded and two outs, the base umpire will position himself in the B position, on the first base side of the mound.
- True
 - False

107. Distance is primary, and angle is secondary. Get close to the play first and get an angle if you have time.
- True
 - False
108. One umpire. On balls hit to the outfield the umpire should move quickly to a working area near the pitcher's mound and adjust to any infield plays as appropriate.
- True
 - False
109. It is a higher priority to watch a runner tag a base than to know where the ball is.
- True
 - False
110. In the two-umpire system, with bases loaded and no outs, on a fly ball to the outfield the plate umpire has any plays at 3B and home. The base umpire has any plays at 1B or 2B.
- True
 - False
111. In a three-umpire system, the plate umpire has the responsibility of calling interference at second base on a double play attempt.
- True
 - False
112. In the three-umpire system, when a fly ball that has a chance to leave the field in flight or bounce over an outfield fence, all umpires should watch the flight of the ball and be ready to provide help to the calling umpire if asked.
- True
 - False
113. Three-umpire system with less than two outs and bases loaded. Is the 3rd base umpire correct to go out on a trouble ball?
- Yes
 - No
114. Two umpire system, runner at 1B and 2B and no outs. On a ground ball to the infield, the plate umpire has calling responsibility for any play on R2 going into 3B if it is the 2nd play in the infield.
- True
 - False
115. Two umpire system, runner at 1B and two outs. On a fly ball near the RF line, the plate umpire's first priority is the fair/foul decision. The base umpire must be prepared to take R1 into 3B and make a call should the plate umpire's responsibilities with the fly ball keep him on the line for an extended period of time.
- True
 - False